

MERCER COUNTY, PA - ADDRESS APPLICATION

◆ Mercer County 911 Emergency Services Address Number is assigned so that each driveway can be quickly located in an emergency based on information supplied on this application. ◆ Accurate distances to intersections, neighboring driveways and other landmarks are important! ◆

The number assigned must be visible from the street and may also be used by the post office.

Return complete form to:

MERCER COUNTY REGIONAL PLANNING COMMISSION

2491 Highland Road, Hermitage, PA 16148

e-mail: mail@mcrpc.com ◆ PHONE: (724) 981-2412 ◆ FAX: (724) 981-7677

www.mcrpc.com

Please accurately measure distances and print clearly on this application!

CONTACT INFORMATION & CURRENT MAILING ADDRESS:

Applicant Name _____

Current Street Address _____

City, State, Zip _____

Best Time to Contact _____

Best Contact Phone # _____ Home Work Cell

Additional Phone # _____ Home Work Cell

PLEASE PROVIDE INFORMATION NEEDED FOR NEW ADDRESS:

Township, Borough, or City of new address: _____

Tax parcel number: _____ - _____ - _____
(this may be obtained from township secretary or tax office)

Previous property owner: _____

Name of your street the driveway connects with: _____

Distance from your driveway to the closest road intersection: (in feet): _____

Name of the closest intersecting road: _____

Standing at the driveway facing the road:

Nearest residence on left: (House #) _____ (Name) _____

Nearest residence on right: (House #) _____ (Name) _____

Residence across road: (House #) _____ (Name) _____

PLEASE DRAW A MAP ON THE BACK OF THIS APPLICATION

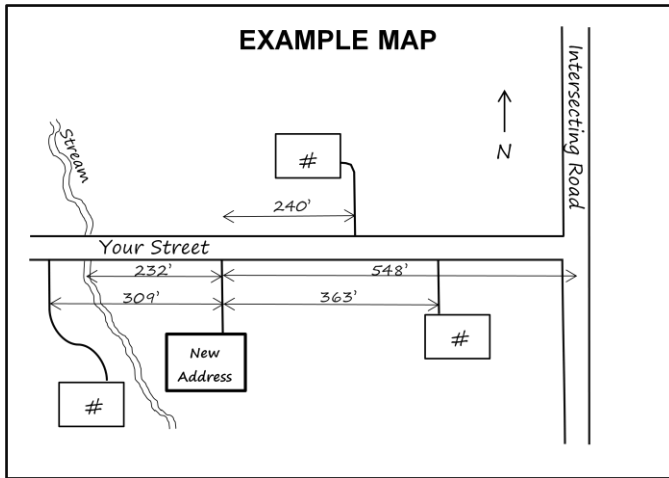

Distances from driveway to other driveways and the closest intersection (measure in feet)

PLEASE SHOW THE FOLLOWING INFORMATION:

- location of **new** or **existing driveway** to your home (or proposed home)
- distance between your **driveway** and the closest intersection
- location of the nearest neighbors and their house numbers
- distance, in feet, from your **driveway** to nearest neighbors' **driveways**

Distances are very important to the addressing process; we count on you to provide accurate measurements in feet.

If available, please include additional information that may be helpful when processing your application:

- Measurements from driveway to streams, utility poles, signs, tree-lines, and other geographic features
- Photographs of the proposed or existing driveway location intersecting the road
- Copy of existing site plans with property lines, property surveys or subdivision plans